

LD4 / LD4D-DG

4" LD Warm Dim Downlight w/ Drop Lens - Non-IC Flat Frame

JOB NAME		CATALOG NUMBER	
NOTES		TYPE	

ELECTRICAL DATA

LED Light Engine	System Wattage *	CCT / CRI	Nominal Delivered Lumens **
L2	17W	3000K to 1800K / 92CRI	1150lm

*System Wattage includes driver & LED Module consumption / **Delivered Lumen output will vary depending on CCT, CRI & finish

FEATURES

- Lutron and enhanced 0-10V dimming options
- Single housing design accepts both round and square trims

LED LIGHT ENGINE

- Warm Dim 3000K to 1800K at 92CRI
- 2 SDCM (2-Step MacAdam)
- 50,000 hours L70 (rated life at 70% output)

ELECTRICAL SYSTEM

- Dedicated voltage options of 120V or 277V. Must be specified in catalog code
- This product complies with IEEE C62.41 for surge endurance up to 2.5KV
- Additional surge protection recommended
- Damage from power surge is not covered by warranty

HOUSING

- 16 & 18 gauge galvanized steel construction
- UL 1598 listed for damp locations

DIMMING

- Forward/reverse phase dimming (120V only)
- 0-10V 1% Dimming
- EldoLED SOLDrive 0-10V 0.1%
- EldoLED ECoDrive 0-10V 1%
- Lutron® LDE1 Hi-Lume 1% EcoSystem LED driver with Soft-on, Fade-to-Black dimming technology
- Lutron® LTEA2W Hi-Lume 1% 2-Wire LED driver (120V forward phase only)

TRIM ASSEMBLY

- Die-cast trim and heat sink assembly with quick connect for easy installation.
- High optical transparency diffusion lens
- Wet location listed

INSTALLATION

- Non-IC; insulation should be kept minimum 3" away from all sides of fixture
- Fixture includes adjustable bar hangers (14"-24") for wood joist or t-bar ceiling installations
- Accommodates ceilings with a 1/2" to 1-1/2" thickness
- Maximum ambient temperature 35°C (95°F)

EMERGENCY

- EM option mounted nearby the fixture above ceiling
- [IOTA PCB diagram](#)
[IOTA ILB-CP instruction Manual](#)

LISTING

- Trim Assembly: ETL listed to US and Canadian standards for wet location
- 5-Year Intense LED Limited Warranty



4" Drop Lens Trim

Ceiling Cut Out: 4-1/2" / Max. Ceiling Thickness: 1 1/2"

Frame-In Part Number (Example: LD4NCL1DIM)

Frame-In	Type	Wattage	Dimming	Voltage	Options
LD4 (LD 4" Flat Frame)	NC (New Construction Non-IC)	L2 (17W)	DIM ¹ (Phase Dimming 5%) D101 (0-10V Dimming 1%) ED10V1 (eldoLED 0-10V 1%) ED10V01 (eldoLED 0-10V 0.1%) LUT (Lutron® LDE1 EcoSystem 1%) LUT2 ¹ (Lutron® LTEA2W 2-Wire 1%)	blank (120V) 27 (277V)	EM7 7W EM Backup

Trim Assembly Part Number (Example: LD4DRWDDG-SFW)

Trim	CCT/CRI	Finish
LD4DR (4" Downlight Round)	WD (3000K-1800K)	DG-SFW (Drop Lens / Self-Flanged White)

Note:
1. Available in 120V only

SPECIFICATION SHEET LM-04722 P-7

INTENSE LIGHTING | 3340 E La Palma Ave, Anaheim, CA 92806 | tel 714 630-9877 | fax 714 630-9883
For Intense Lighting's limited product warranty, go to www.intenselight.com. For a printed copy of the warranty, you may call 800 961-5321.
© 2022 Intense Lighting, LLC. All rights reserved. Note: This document is subject to change without notice.

intense[®] | a LEVITON[®] company
LIGHTING

LD4 / LD4D-DG

4" LD Warm Dim Downlight w/ Drop Lens - Non-IC Flat Frame

JOB NAME		CATALOG NUMBER	
NOTES		TYPE	

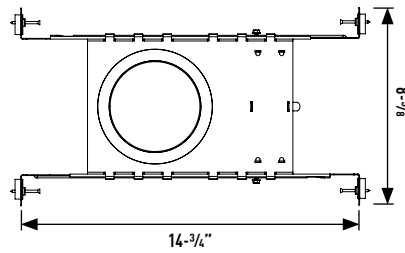
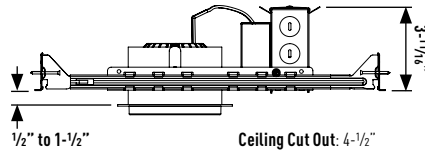
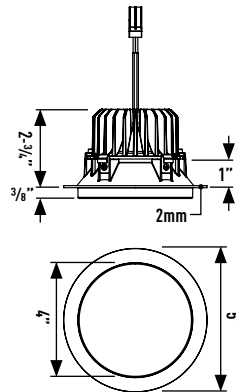

0-10V DIMMING ELECTRICAL TABLE

Lumen Package	Voltage	Wattage	VA	Input Current	Power Factor
L05	120V	-	-	-	-
	277V	-	-	-	-
L0	120V	9.2W	9.85	0.08	0.93
	277V	10.28W	13.79	0.05	0.75
L4	120V	11.46W	11.90	0.10	0.96
	277V	12.59W	16.43	0.06	0.77
L2	120V	16.95W	17.36	0.14	0.98
	277V	18.28W	20.99	0.08	0.87

PHASE DIMMING ELECTRICAL TABLE

Lumen Package	Voltage	Wattage	VA	Input Current	Power Factor
L05	120V	5.07W	5.16	0.04	0.98
	277V	-	-	-	-
L0	120V	7.87W	7.92	0.07	0.99
	277V	9.32W	10.48	0.04	0.89
L4	120V	10.74W	10.81	0.09	0.99
	277V	11.9W	12.9	0.05	0.92
L2	120V	16.93W	17.26	0.14	0.98
	277V	17.77W	19.15	0.07	0.93

LD4 / LD4D-DG

4" LD Warm Dim Downtlight w/ Drop Lens - Non-IC Flat Frame

JOB NAME		CATALOG NUMBER	
NOTES		TYPE	

LC4L4 / LD4DRWDDG-SFW

REPORT #: 20210312-1.002

CCT MULTIPLIERS (90CRI):

2700K (x 1.00)
 3000K (x 1.00)
 3500K (x 1.00)
 4000K (x 1.00)

TRIM FINISH MULTIPLIERS:

White (x 1.00)
 Black (x 0.85)
 Satin Nickel (x 0.91)

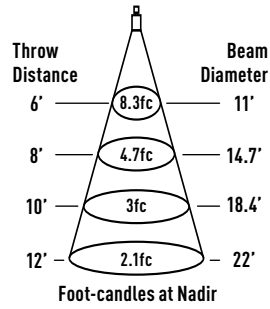

Watts: 8 LPW: 75
 Lumens: 600 CCT: 3000K

Intensity	
Degree	CBCP
0°	299
5°	296
15°	275
25°	240
35°	193
45°	131

LC4L3 / LD4DRWDDG-SFW

REPORT #: 20210312-1.001

CCT MULTIPLIERS (90CRI):

2700K (x 1.00)
 3000K (x 1.00)
 3500K (x 1.00)
 4000K (x 1.00)

TRIM FINISH MULTIPLIERS:

White (x 1.00)
 Black (x 0.85)
 Satin Nickel (x 0.91)

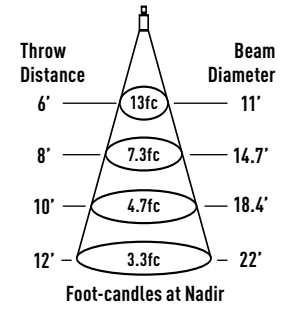

Watts: 11 LPW: 81.8
 Lumens: 900 CCT: 3000K

Intensity	
Degree	CBCP
0°	468
5°	464
15°	430
25°	377
35°	302
45°	206

LC4L4 / LD4DRWDDG-SFW

REPORT #: 20210312-1.003

CCT MULTIPLIERS (90CRI):

2700K (x 1.00)
 3000K (x 1.00)
 3500K (x 1.00)
 4000K (x 1.00)

TRIM FINISH MULTIPLIERS:

White (x 1.00)
 Black (x 0.85)
 Satin Nickel (x 0.91)

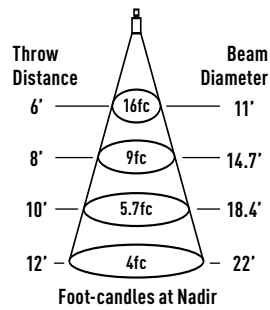

Watts: 14 LPW: 82.14
 Lumens: 1150 CCT: 3000K

Intensity	
Degree	CBCP
0°	575
5°	570
15°	528
25°	462
35°	371
45°	253