

GC4DR

4" Gravity BIOS Downlight Cylinder

JOB NAME		CATALOG NUMBER	
NOTES		TYPE	

ELECTRICAL DATA: (Data Based On 3000K/82CRI Configuration)

LED Light Engine	Nominal Delivered Lumen*	System Wattage**	Efficacy	LED Light Engine	Nominal Delivered Lumen*	System Wattage**	Efficacy
BS05	500lm	9W	56 lm/W	BS02	1500lm	26W	58 lm/W
BS01	1000lm	17W	59 lm/W	BS03	2000lm	33W	61 lm/W

*System Wattage include driver and LED Module consumption. / ** Delivered lumens will vary depending on CCT, CRI and optic selection

FEATURES

- BIOS Illuminated: Blue Spectrum Peak Emission at 490 nm
- High performance cylinder extruded from aluminum in durable powder coat finishes
- Control protocols from ELV, 0-10V, 2-Wire, DALI and DMX with options available in 0.1% and dim-to-dark

LED LIGHT ENGINE

- 3000K, 3500K or 4000K w/ CRI 80+ and R9 > 90
- 2 Step MacAdam (2 SDCM)
- Rated life of >50,000 hours L70 based on LED testing per LM-80-08 and projected values using IESNA TM21-11

DIMMING

- Phase Dimming 120V only, Forward 1% / Reverse 5%
- 0-10V Dimming 1%
- elDoLED 0-10V 0.1% or 1%
- Lutron® LDE1 Hi-Lume 1% EcoSystem LED driver with Soft-on, Fade-to-Black dimming technology
- Lutron® LTEAZW Hi-Lume 1% 2-Wire LED driver (120V forward phase only)
- DMX512 RDM 0.1% (Available with aircraft cable only)

OPTICS

- 20° Spot, 30° Narrow Flood, 40° Flood and 50° Wide Flood
- Optics and filter media are field customizable

ELECTRICAL SYSTEM

- Dedicated voltage options of 120V or 277V. Must be specified in catalog code.
- This product complies with IEEE C62.41 for surge endurance up to 2.5KV. Additional surge protection recommended. Damage from power surge is not covered by warranty.

REMOTE DRIVER & EMERGENCY BACKUP OPTIONS

For remote driver or emergency backup options please see **GC4DRREM**

REFLECTOR

Specification grade reflector with 1.5mm thickness. Reflector available in haze, white, clear, black or wheat finish. Consult factory for other colors. Architectural, discrete polished self flange standard. Meets RP-1 requirements with controlled light distribution at a 55° cut off.

MOUNTING

- Surface mount for direct installation to 3" or 4" Octagonal J-Box.
- 144" Aircraft cable is supplied with canopy assembly.
- Aircraft cable with DMX dimming, supplied with smart canopy.
- Wall mount bracket for installation to 4" Octagonal J-Box.
- Pendant stems supplied with complete canopy assembly.
- Supplied aircraft cables and slope pendant stems are cuttable and can be modified in the field.
- Stem length available from 12-inch to 96-inches. Accessories plate available, see next page for ordering info.

ACCESSORIES

Luminaire will accommodate (2) accessories, accessory holder required.

LISTING / WARRANTY

- ETL Listed to US and Canadian standards for damp locations
- 5-Year Intense LED Limited Warranty



Gravity™



Dimension are on Page 2

Accessories

LH63	(Black Accessory Holder)
LH63W	(White Accessory Holder)
PFL2-63	(Linear Spread Lens)
PFL4-63	(Solite Soft Focus Lens)
PFLMB-63	(Black Hex Louver)

Cylinder Part Number (Example: N/A TBD)

Cylinder	Wattage	CCT / CRI	Dimming	Voltage	Optic
GC4DR	BS05 ¹ (9W)	30 (3000K / 80 CRI)	DIM ³ (Phase Dimming)	blank (120V)	-SP (20° Spot)
	BS1 (17W)	35 (3500K / 80 CRI)	D101 (0-10V Dimming 1%)	27 (277V)	-NF (30° Narrow Flood)
	BS2 (26W)	40 (4000K / 80 CRI)	ED10V1 (elDoLED 0-10V 1%)		-FL (40° Flood)
	BS3 (33W)		ED10V01 (elDoLED 0-10V 0.1%)		-WF (50° Wide Flood)
			LUT (Lutron® LDE1 EcoSystem 1%)		
			LUT2 ³ (Lutron® LTEAZW 2-Wire 1%)		
			DMXR (DMX512 RDM 0.1%)		

Cylinder Finish	Reflector Finish	Mounting
W (White)	HZ (Haze)	C144 (144" Aircraft Cable)
B (Black)	W (White)	P12 (12" Slope Pendant)
SV (Silver)	C (Clear)	P24 (24" Slope Pendant)
	B ² (Black)	P36 (36" Slope Pendant)
	WHT ² (Wheat)	P48 (48" Slope Pendant)
		P96 ⁴ (96" Slope Pendant)
		WB (Wall Bracket)
		S (Surface)

Notes:

- BS05 Not Available With (DIM) Phase Dimming
- Consult factory for lead times
- Available in 120V only
- (2) 48" Stems With Coupler

GRAVITY CYLINDERS LM-0420.22 P-1

INTENSE LIGHTING | 3340 E La Palma Ave, Anaheim, CA 92806 | tel 714 630-9877 | fax 714 630-9883

For Intense Lighting's limited product warranty, go to www.intenselighting.com. For a printed copy of the warranty, you may call 800 961-5321.

© 2022 Intense Lighting, LLC. All rights reserved. Note: This document is subject to change without notice.

GC4DR

4" Gravity BIOS Downlight Cylinder

JOB NAME		CATALOG NUMBER	
NOTES		TYPE	

Surface Mount

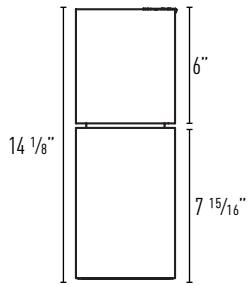

Wall Mount

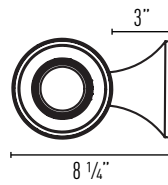
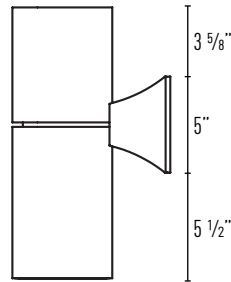

Slope Pendant Mount

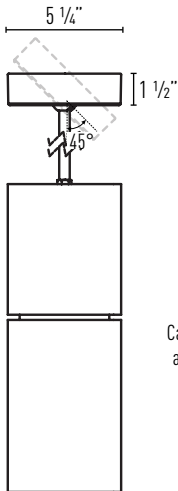

Canopy can be mounted at a maximum angle of 45°

Aircraft Cable

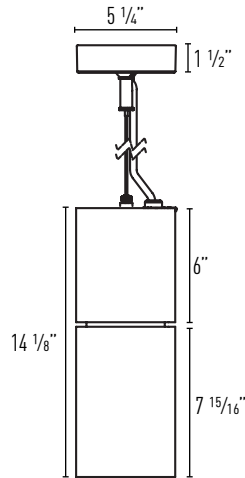

GC4DR

4" Gravity BIOS Downlight Cylinder

JOB NAME		CATALOG NUMBER	
NOTES		TYPE	

0-10V Dimming Electrical Table: System Wattage

Lumen Package	Voltage	Wattage	VA	Input Current	Power Factor
BS05	120	8.15	8.98	0.07	0.908
	277	8.47	12.50	0.05	0.678
BS1	120	15.85	16.18	0.13	0.980
	277	16.45	19.51	0.07	0.843
BS2	120	25.41	25.75	0.21	0.987
	277	25.9	29.25	0.11	0.885
BS3	120	32.64	32.91	0.27	0.992
	277	33.12	36.89	0.13	0.898

Phase Dimming Electrical Table: System Wattage

Lumen Package	Voltage	Wattage	VA	Input Current	Power Factor
BS1	120V	15.40W	15.87	0.13	0.970
	277V				
BS2	120V	24.80W	25.22	0.21	0.983
	277V				
BS3	120V	31.96W	32.94	0.27	0.970
	277V				

BIOS Dynamic SkyBlue - High M/P Ratio SPD (3500K Day)

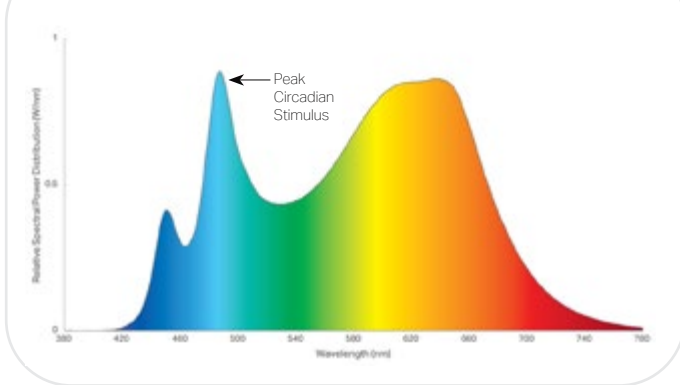

BIOS Dynamic SkyBlue - Low M/P Ratio SPD (2700K Night)

